

# Unit 802 - Palm Aire 60

802 - 605 Oaks Dr, Pompano Beach, FL, Broward 33069

## Unit Information

MLS Number: F10402021  
 Status: Active  
 Size: 1,150 Sq ft.  
 Bedrooms: 2  
 Full Bathrooms: 2  
 Half Bathrooms: 0  
 Parking Spaces: 1 Space  
 View: Golf View  
 List Price: \$305,000  
 List PPSF: \$265  
 Valuated Price: \$257,000  
 Valuated PPSF: \$223

*The above valuated price is a baseline figure that does not take into account any specific renovation, upgrade, split, merge, or deterioration of the unit.*

## Building Information

Number of units: 100  
 Number of active listings for rent: 0  
 Number of active listings for sale: 3  
 Building inventory for sale: 3%  
 Number of sales over the last 12 months: 4  
 Number of sales over the last 6 months: 3  
 Number of sales over the last 3 months: 2

## Building Association Information

Mwi/Campbell Management Co, Palm Aire Country Club Condominium Association  
 3500 Gateway Drive # 202  
 Pompano Beach, FL33069-4870  
 (954) 968-448

## Recent Sales

Unit #	Size	Closing Date	Sale Price	PPSF
307	1,150 sq ft	Apr 2024	\$220,000	\$191
807	1,064 sq ft	Mar 2024	\$225,000	\$211
704	1,150 sq ft	Dec 2023	\$220,000	\$191
909	1,150 sq ft	Jun 2023	\$250,000	\$217

## Market Information

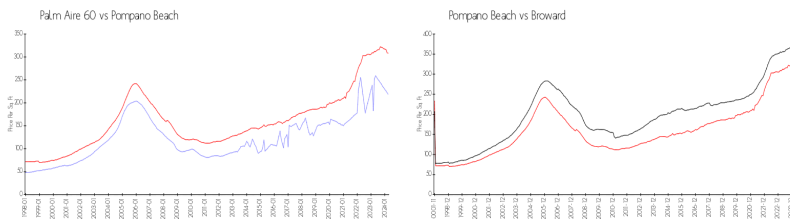

Palm Aire 60: \$218/sq. ft.  
 Pompano Beach: \$308/sq. ft.  
 Pompano Beach: \$308/sq. ft.  
 Broward: \$351/sq. ft.

## Inventory for Sale

Palm Aire 60: 3%  
 Pompano Beach: 3%  
 Broward: 4%

## Avg. Time to Close Over Last 12 Months

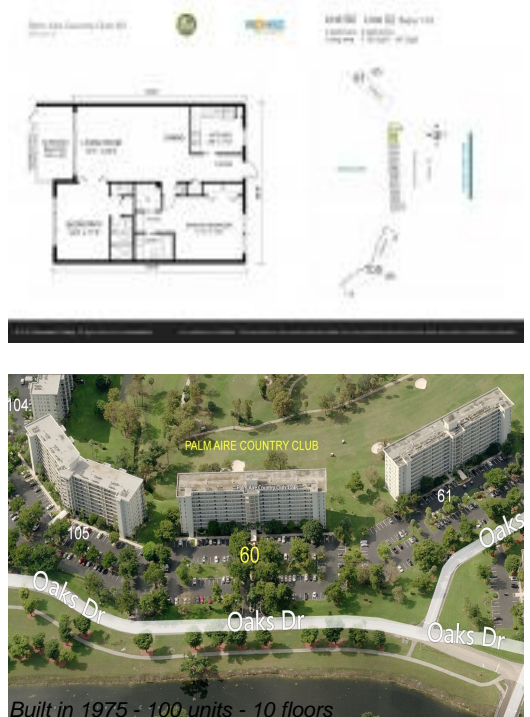

Palm Aire 60  
Pompano Beach  
Broward

93 days  
73 days  
67 days