

Unit 411 N Cypress Dr # 15C - Wendimere Villas

411 N Cypress Dr # 15C - 407 N Cypress Dr, Jupiter, FL, Palm Beach 33469

Unit Information

MLS Number:	RX-10943799
Status:	Active
Size:	1,024 Sq ft.
Bedrooms:	2
Full Bathrooms:	1
Half Bathrooms:	1
Parking Spaces:	Assigned, Guest
View:	Other
List Price:	\$280,000
List PPSF:	\$273
Valuated Price:	\$266,000
Valuated PPSF:	\$260

The above valuated price is a baseline figure that does not take into account any specific renovation, upgrade, split, merge, or deterioration of the unit.

Building Information

Number of units:	33
Number of active listings for rent:	0
Number of active listings for sale:	1
Building inventory for sale:	3%
Number of sales over the last 12 months:	1
Number of sales over the last 6 months:	0
Number of sales over the last 3 months:	0

Building Association Information

Windemere Owners Association
FirstService Residential
2950 North 28th Terrace
Hollywood, Florida 33020

<https://www.fsresidential.com/florida/news-events/press-releases/firstservice-re>

Recent Sales

Unit #	Size	Closing Date	Sale Price	PPSF
3	1,024 sq ft	Jul 2023	\$277,500	\$271

Market Information

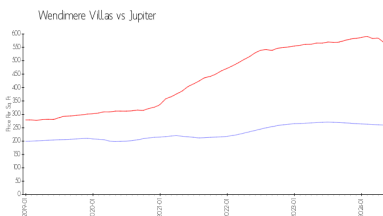

Windemere Villas: \$260/sq. ft.
Jupiter: \$566/sq. ft.

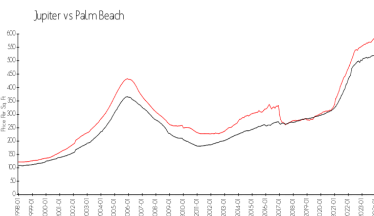

Jupiter: \$566/sq. ft.
Palm Beach: \$476/sq. ft.

Inventory for Sale

Windemere Villas	3%
Jupiter	3%
Palm Beach	3%

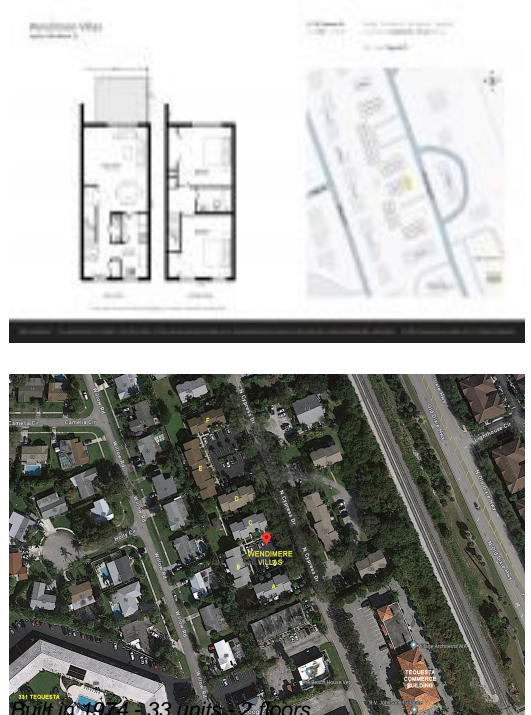

Avg. Time to Close Over Last 12 Months

Wendimere Villas	n/a
Jupiter	67 days
Palm Beach	57 days