

# Unit 1016 - Bridgewater Place

1016 - 115 112th Ave NE, St Petersburg, FL, Pinellas 33716

## Unit Information

MLS Number:	TB8423392
Status:	ACTIVE
Size:	516 Sq ft.
Bedrooms:	1
Full Bathrooms:	1
Half Bathrooms:	0
Parking Spaces:	Common, Guest, Off Street, Open
View:	Water
List Price:	\$150,000
List PPSF:	\$291
Valuated Price:	\$124,000
Valuated PPSF:	\$240

*The above valuated price is a baseline figure that does not take into account any specific renovation, upgrade, split, merge, or deterioration of the unit.*

## Building Information

Number of units:	260
Number of active listings for rent:	0
Number of active listings for sale:	4
Building inventory for sale:	1%
Number of sales over the last 12 months:	3
Number of sales over the last 6 months:	2
Number of sales over the last 3 months:	1

## Building Association Information

Bridgewater  
115 112th Ave NE,  
St. Petersburg, FL 33716  
phone:(727) 577-5416  
Fax: (727) 563-9214

<https://www.psdm-bridgewater.com/>

## Recent Sales

Unit #	Size	Closing Date	Sale Price	PPSF
310	942 sq ft	Nov 2025	\$195,000	\$207
1027	1,058 sq ft	Jul 2025	\$240,000	\$227
114	935 sq ft	Mar 2025	\$185,000	\$198

## Market Information

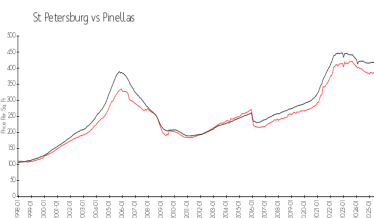
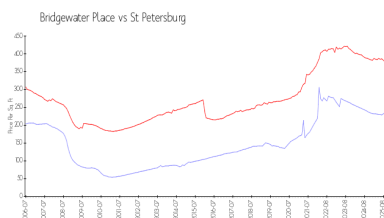

Bridgewater Place: \$243/sq. ft.  
St Petersburg: \$376/sq. ft.

St Petersburg: \$376/sq. ft.  
Pinellas: \$387/sq. ft.

## Inventory for Sale

Bridgewater Place	2%
St Petersburg	9%
Pinellas	8%

## Avg. Time to Close Over Last 12 Months

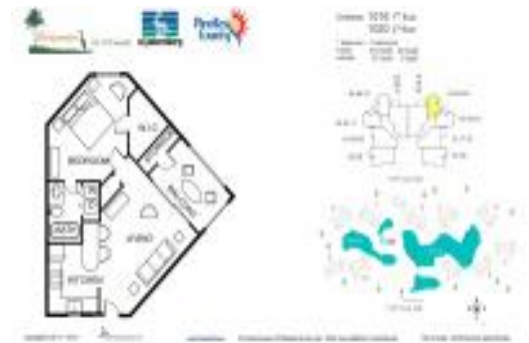

Bridgewater Place  
St Petersburg  
Pinellas

83 days  
95 days  
100 days